



1. Safety instructions during assembly

The LubeTronic 5Point must only be assembled and repaired by a qualified professional!

To carry out the work required, the fifth wheel coupling must be removed from the tractor unit as per the JSK 37 or JSK 42 assembly and operating manual and laid with the underside facing upwards on a suitable work bench. The pedestals must be removed as per the JSK or JSK 42 repair manual.

The assembly and operating manuals, as well as repair manuals, can be found on JOST's website. See www.jost-world.com.

Tools required

- ▶ Diagonal cutters
- ▶ Torx T30 screwdriver
- ▶ SW8 open-ended wrench
- ▶ SW13 open-ended wrench

Material required

Spare parts kit, comprising:

- ▶ LubeTronic 5Point
- ▶ 5 x cable ties
- ▶ 4 x Torx M6 x 10 mm flat-head screws
- ▶ 1 x Torx M6 x 16 mm flat-head screws
- ▶ Spare lubrication tube

2. Handling the lubrication tubes

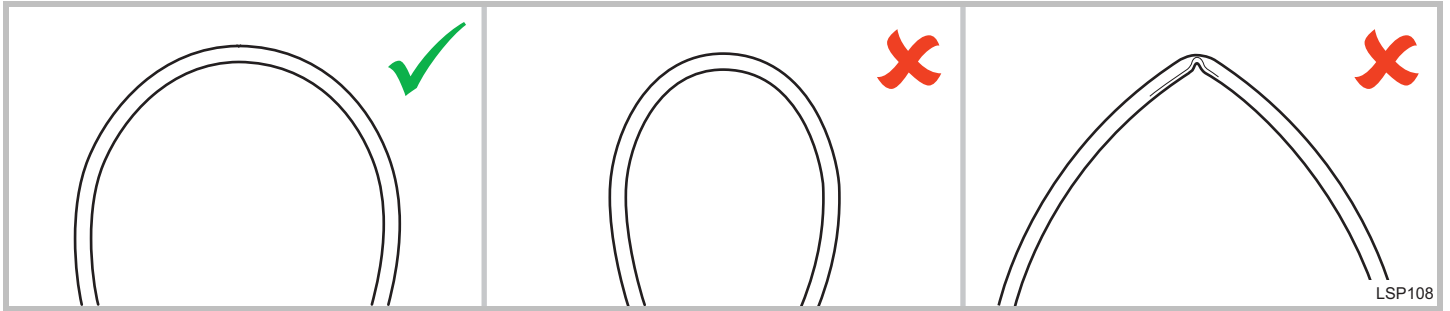

Fig. 1: Adequate bending radius

Fig. 2: Bending radius too small

Fig. 3: Kink point due to bending radius being too small

When routing the lubrication tubes, avoid bending radii that are too small (Fig. 2), since these could lead to kinks (Fig. 3). If the lubrication tubes are kinked during assembly, they must be replaced. Spare tubes can be ordered under article number SKE006620200.

- ⚠ The lubrication tubes must be cut to the required length. Use the tube being replaced as a guide. Only use suitable tools to cut the tubes to size. Ensure that the cut edges are clean and neat.**

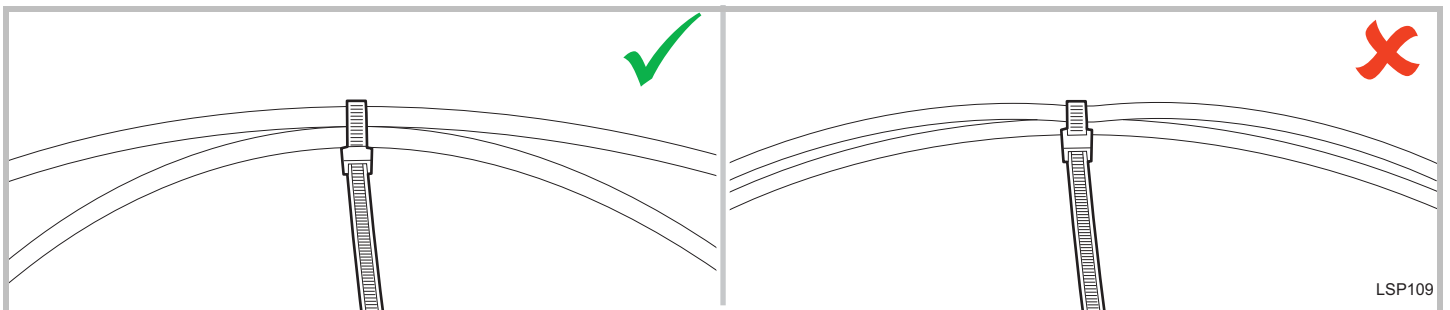

Fig. 4: Cable ties correctly secured

Fig. 5: Cable ties pulled too tight

When securing with cable ties, care must also be taken to avoid pinching (Fig. 5). If a cable tie has been pulled too tight, it must be replaced with one that has been tied correctly.

3. Removing an installed LubeTronic 5Point

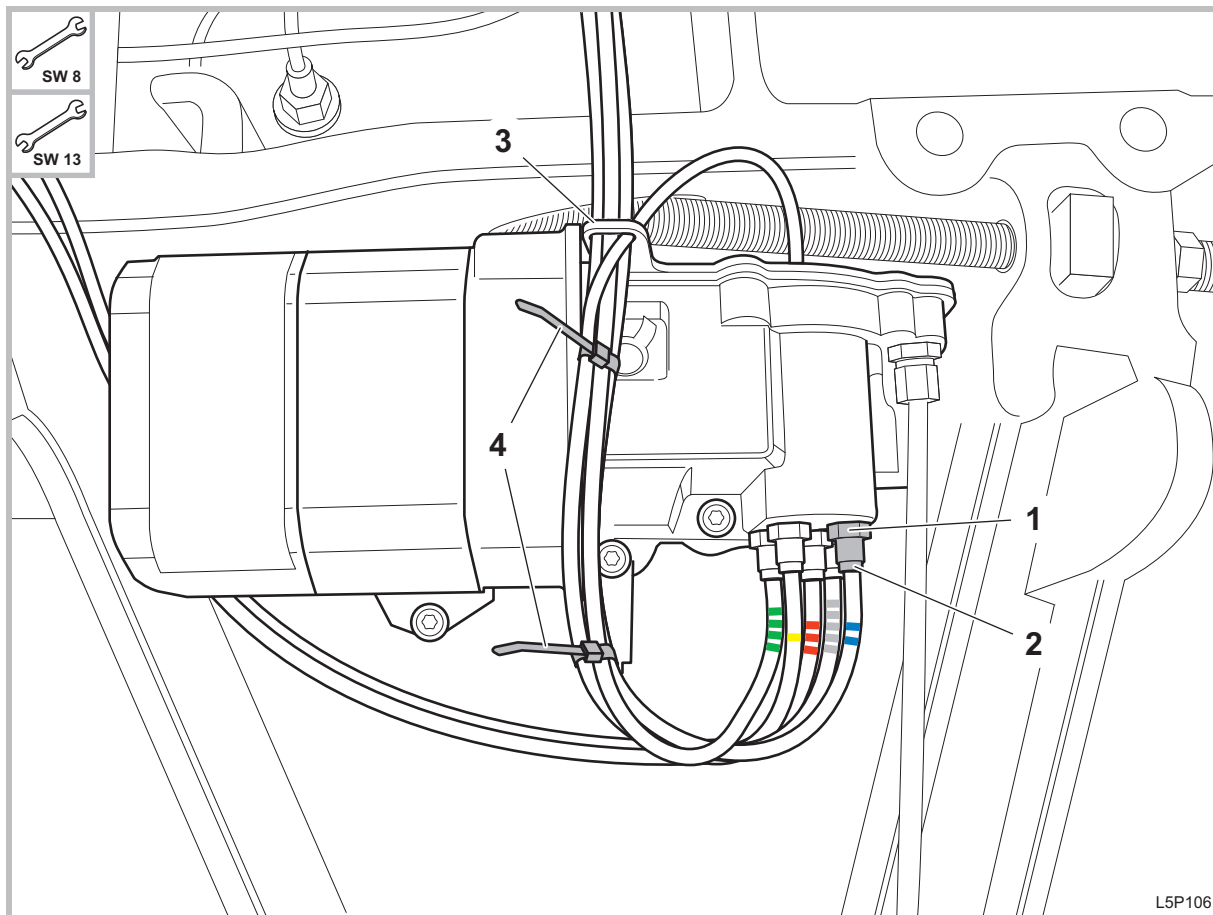

Fig. 6: LubeTronic 5Point, mark the lubrication tubes

- ▶ Loosen the locking nuts (2) on the tube screws (1) using the SW8 open-ended wrench.
- ▶ While doing so, secure the tube screw (1) using the SW13 open-ended wrench.
- ▶ Clearly mark the position of the lubrication tubes from the cable screws.
- ▶ Remove the cable ties (4) on the lubrication tubes and pull the tubes through the retaining eyelet (3).

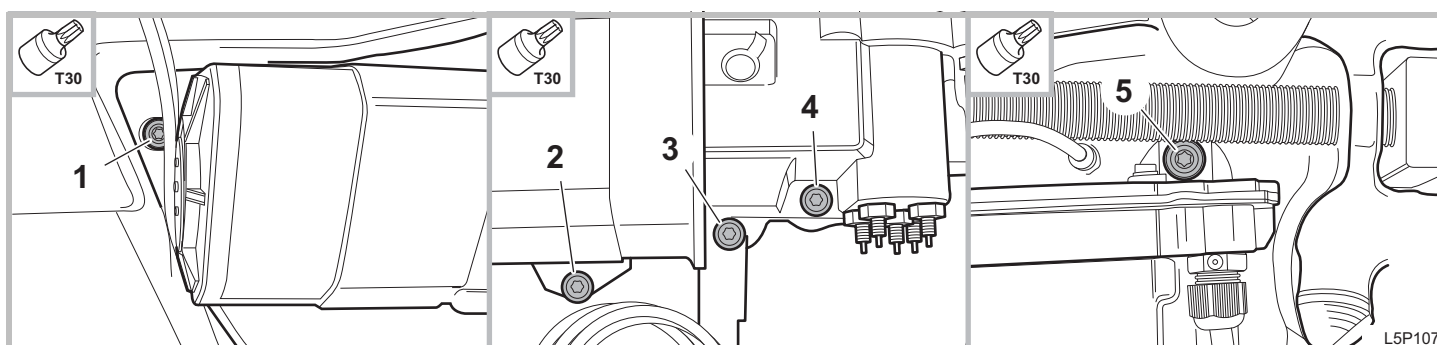

Fig. 7: Position of screw 1

Fig. 8: : Positions of screws 2, 3 and 4

Fig. 9: Position of screw 5

The LubeTronic 5Point is secured to the fifth wheel coupling plate with a total of five screws.

- ▶ Loosen the assembly screws of the LubeTronic 5Point with a Torx T30 screwdriver.
- ▶ The LubeTronic 5Point can now be removed.
- ▶ Screws 1 and 5 have spacer sleeves on them. These must be stored and reused during assembly.

4. Assembling the replacement unit

 Only the screws and locking devices supplied must be used.

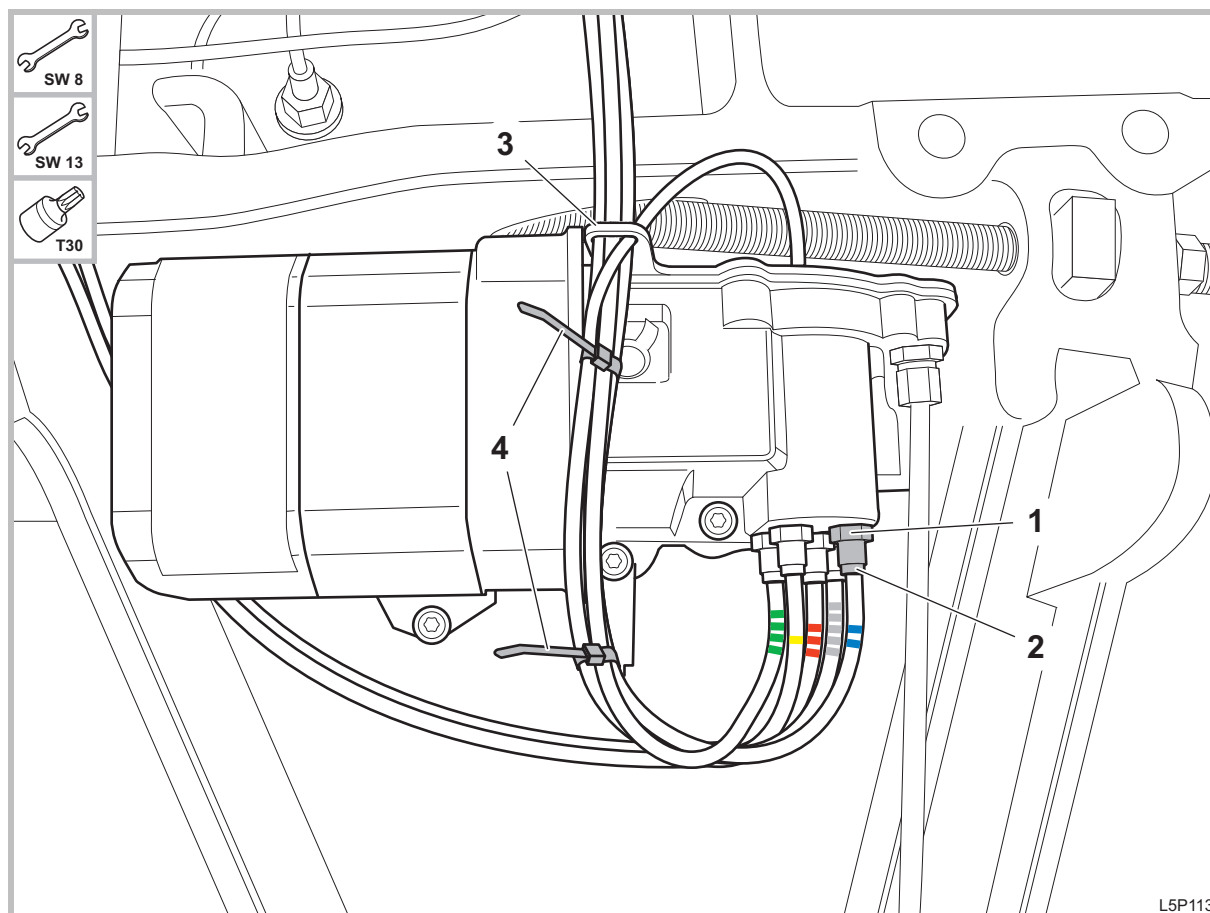
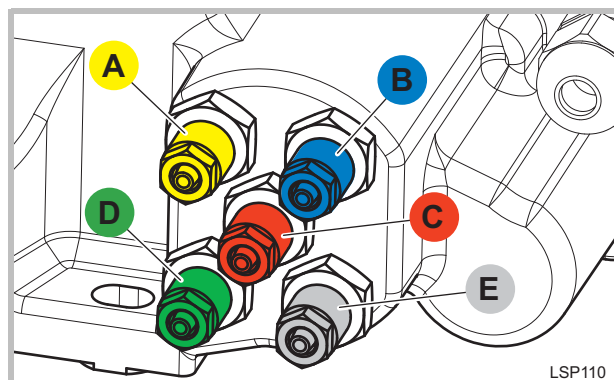

Fig. 10: LubeTronic 5Point, assembled

- ▶ The spacer sleeves removed previously must be reused on screws 1 and 5.
- ▶ Place the new LubeTronic 5Point in position and secure to the original screw points with the screws supplied.
- ▶ Tightening torque: $6.5 \text{ Nm} \pm 1.5 \text{ Nm}$.

 **Lubrication tubes must not be kinked!**
When tightening the cable ties, cable tie pliers must be used in order to avoid damaging the cables and lubrication tubes.

- ▶ Guide the lubrication tubes through the retaining eyelet (3) and secure with cable ties (4).
- ▶ Place the lubrication tubes on the relevant tube screw connections (1) and tighten the locking nuts (2) to a tightening torque of $4 \text{ Nm} \pm 1 \text{ Nm}$.



Number	Colour code
A	Yellow
B	Blue
C	Red
D	Green
E	White

Fig. 11: Connection diagram for the lubrication tubes

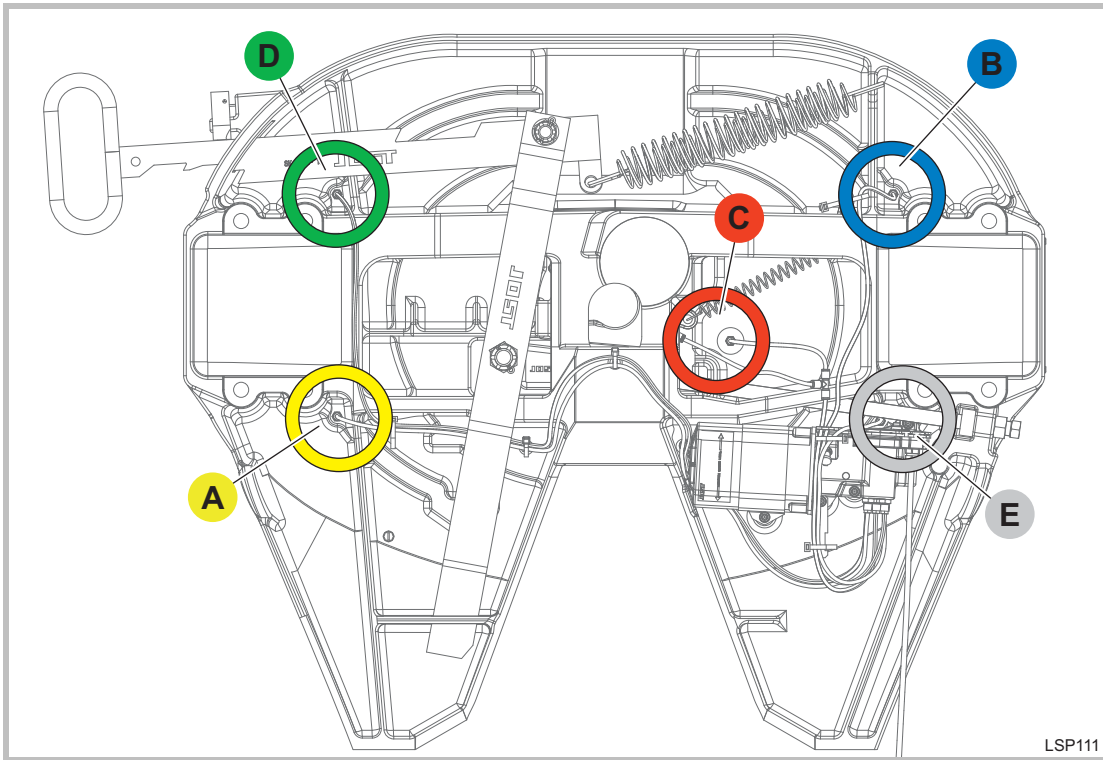

LSP111

Fig. 12: Connection diagram for JSK 37

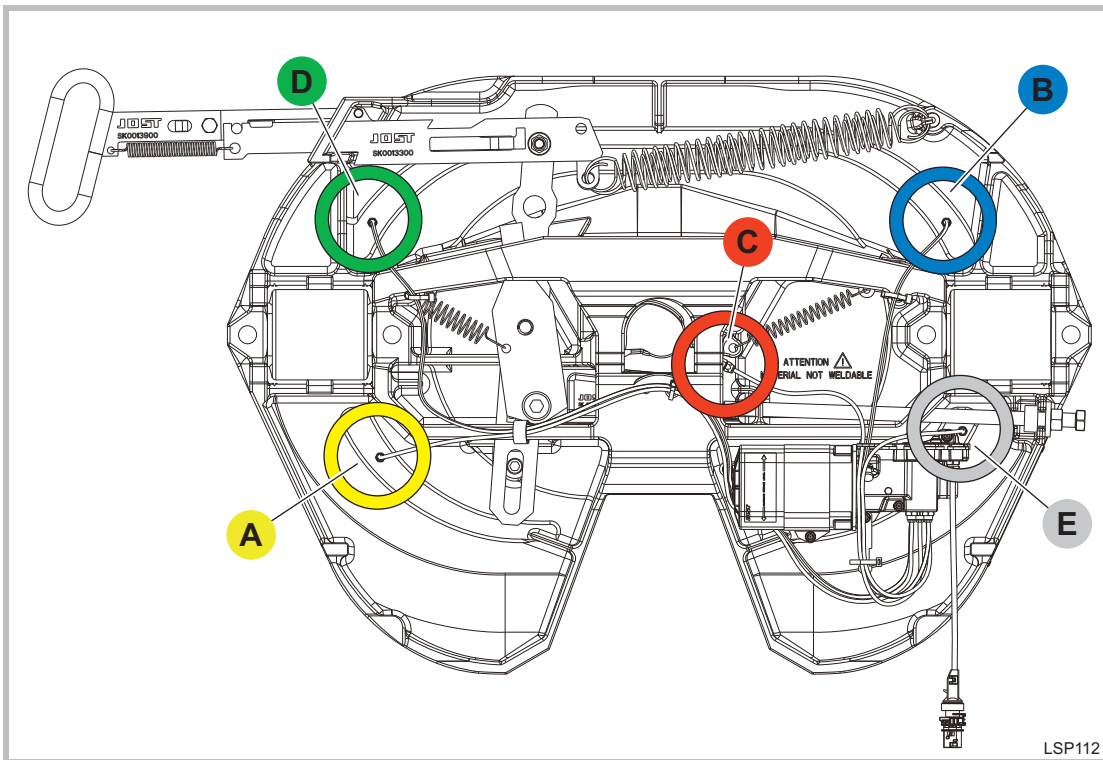

LSP112

Fig. 13: Connection diagram for JSK 42

The LubeTronic 5Point is now fully assembled.